



SmartGen
ideas for power

HT SERIES

(HT10, HT22)

WATER ENGINE HEATER

USER MANUAL



SMARTGEN (ZHENGZHOU) TECHNOLOGY CO., LTD.

3 TECHNICAL PARAMETERS

HT series water heaters are divided into 4 types according to the power of the internal heating pipes; their case and installation dimensions are all the same. Specific parameters are given below:

Model	HT10	HT22
Rated Power	1190W (22V1000W)	2200W (220V1850W)
Rated Voltage	240V	
Rated Current	5A	9.2A
Engine Displacement (L)	0~7	7~13
Thermostat Set Point	40°C±3 °C	
Thermostat Range	Standard: Off: 40 °C±3 °C On: 25 °C±6 °C	
	HT05-1, HT10-1, HT15-1, HT22-1: Off: (50±3)°C On: (35±6)°C	
	HT05-2, HT10-2, HT15-2, HT22-2: Off: (60±3)°C On: (45±6)°C	
Overheating Thermostat Range	Off: 95 °C±3 °C On: 80 °C±6 °C	
Insulating Resistance	≥50MΩ	
Electrical Strength	AC 1.5kV 1min	
Inlet/Outlet Size	3/4" (φ 19mm)	
Max. Water Pressure	0.5MPa	
Protection Level	IP54	
Vibration Resistance	(5~8)Hz; Amplitude±7.5mm; Triaxial (8~500)Hz; a=2g; Triaxial	
Shock Resistance	Half-sine Wave; a _{peak} =50g; Triaxial	
Working Conditions	-25 °C~+70 °C	
Storage Conditions	-30 °C~+70 °C	
Case Dimensions	203mm×150mm×177mm	
Weight	1.2kg	

4 INDICATOR

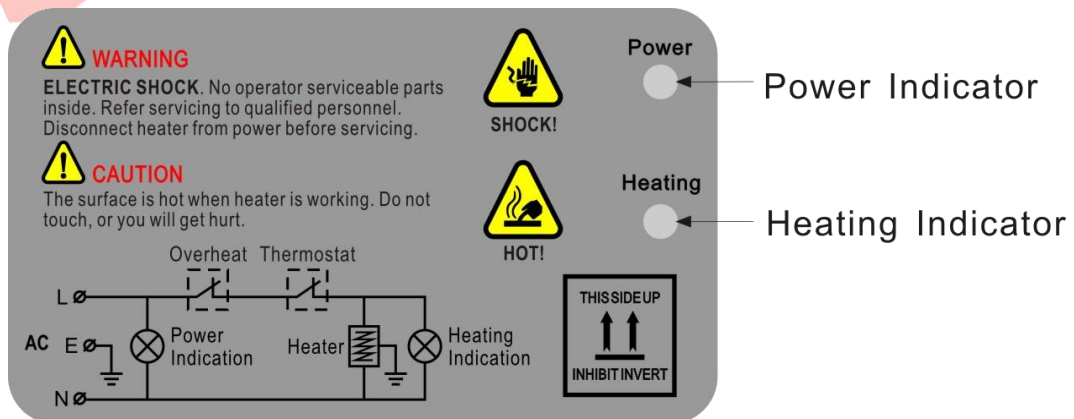

5 CONNECTIONS

The supplied power cable is 1.2m long. Please follow the back cover application diagram when wiring; earth line must be soundly connected to earth.

In the above diagram: L--Phase line (Red), N-Neutral line (Green), E-Earth line (Yellow).

6 HEATER CONNECTION

Please install the heater vertically according to the diagram before use. Paying attention to direction of heater inlet and outlet, and ensure that the heater position is below the lowest water level of the engine and that all the air is exhausted out of the heater and it is topped off with water.

Heater connection diagram:

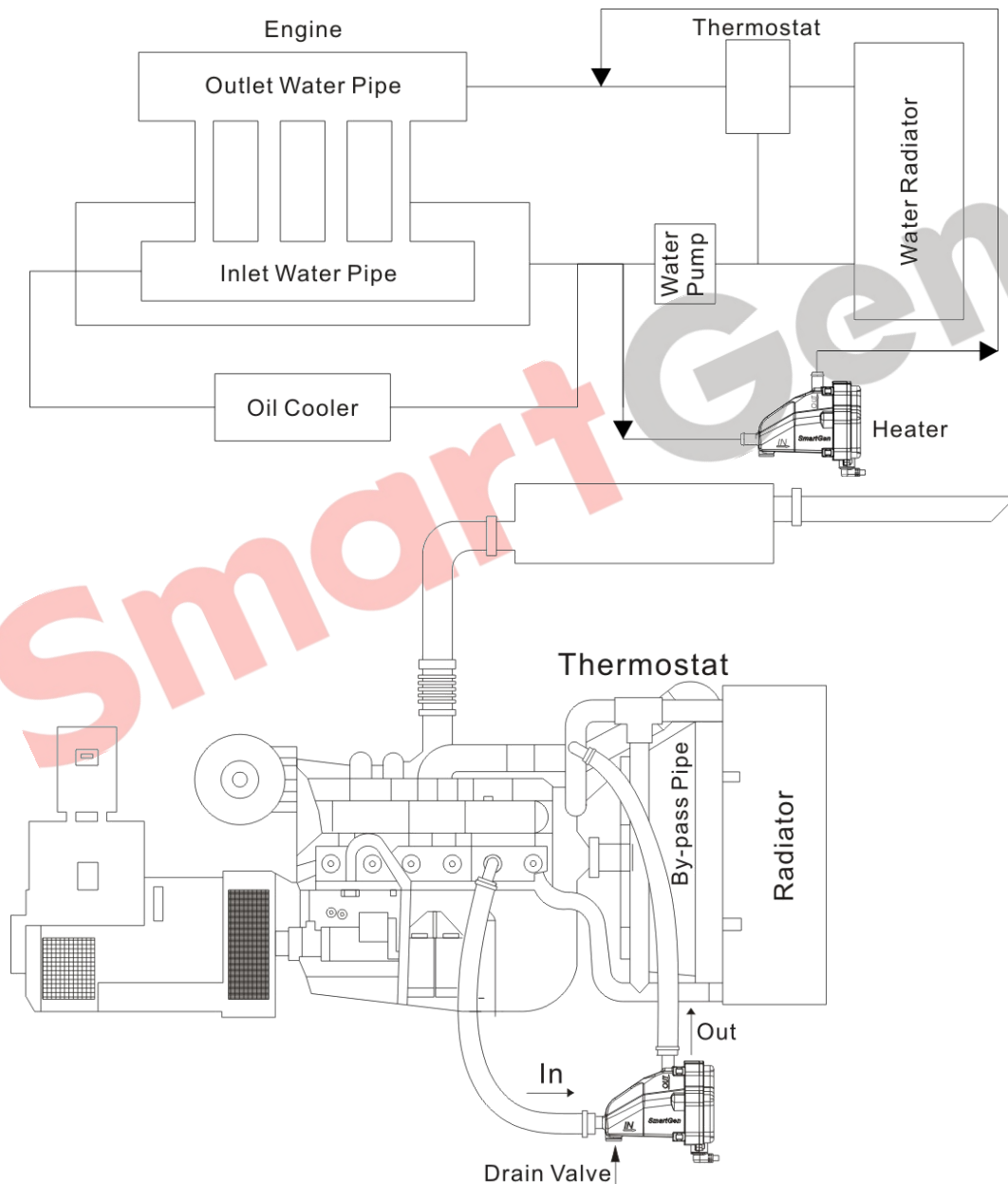

7 INSTALLATION INSTRUCTION

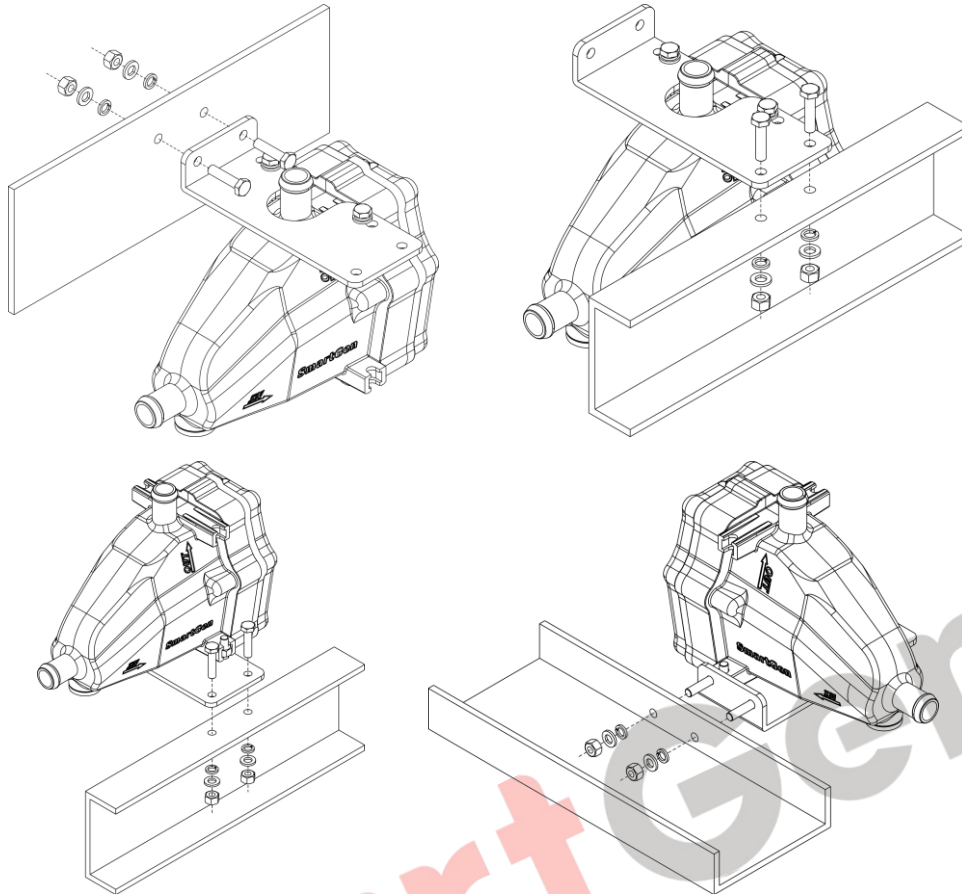

8 CAUTION

Before starting the machine, ensure that all the air is exhausted out of the heater and it is topped off with coolant. If water is used, please drain it off when generator is stopped to avoid internal corrosion. Otherwise, the remaining water freezes when temperature is lower than 0°C, which can damage the enclosure.

Corresponding antifreeze is strongly recommended.

Earth line must be soundly connected to earth.

Drain valve: Can be opened or closed using hexagonal tools.

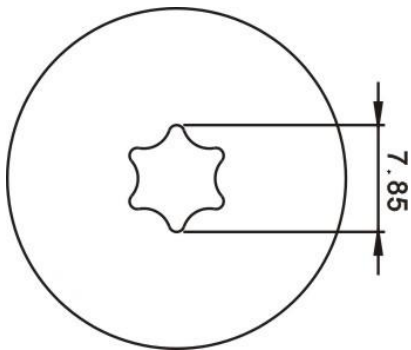

9 CASE AND INSTALLATION DIMENSIONS

(Unit: mm)

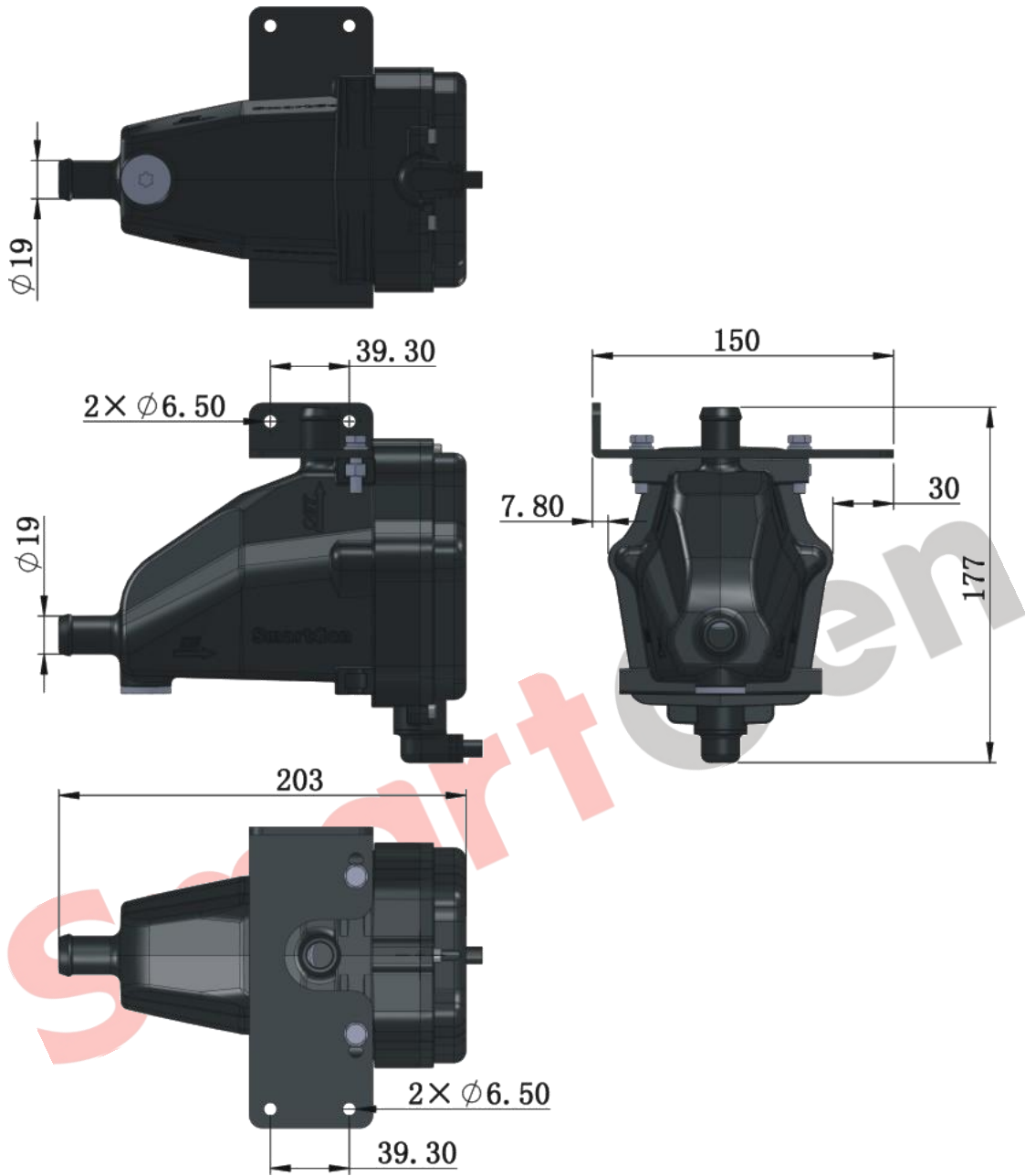



10ADDITION: HEATER PACKING LIST

No.	Name	Number	Remarks
1	Heater	1	
2	Bracket	1	
3	Flat gasket	4	GB/T 95 6
4	Spring washer	4	GB/T 93 6
5	Hexagon nut	4	GB/T 6170 M6
6	Hexagon screws	4	GB/T 5783 M6×25
7	Hose clamps	4	Φ 18-Φ 33
8	Certificate	1	
9	User Manual	1	

SmartGen